



E-Collar Technologies

2120 Forrest Park Drive
Garrett, IN 46738-1887

1-855-326-5527 (Toll Free)
1-855-226-5527 (Toll-Free Fax)
1-260-357-0051 (International)
sales@ecollar.com

www.ecollar.com

Patents Pending

© 2014 E-Collar Technologies, Inc.



Thank you for Supporting American Workers



Pro Educator PE-900

Quick Start Guide

E-Collar Technologies, Inc.

CONTACT INFORMATION



E-Collar Technologies, Inc.
2120 Forrest Park Drive
Garrett, IN 46738
Toll-Free 1-855-326-5527
Toll-Free Fax 1-855-226-5527
International : 1-260-357-0051
www.ecollar.com
sales@ecollar.com
customerservice@ecollar.com

This product is covered by various patents including but not limited to patents 8757098 and 8833309. Patent is pending on the Instant Stimulation Feature on this device.

Copyright 2014 E-Collar Technologies, Inc. All Rights Reserved.

Welcome to the World of Low Level E-Collar Training

Thank you for trusting us with your e-collar purchase, we appreciate it and will do everything possible to exceed your expectations.

We have taken great care to provide ample safety features to assure a pleasant experience for you and your dog.

It is important to condition your dog to low level stimulation by pairing it with soft leash pressure; you will always get better results with low level stimulation combined with consistent training techniques and a patient heart. The use of high levels of stimulation should only be used as a last resort and in life-threatening situations.

We recommend all first time e-collar users obtain professional help or immerse themselves in the many online resources.

Feel free to contact our customer service to obtain information on a professional trainer well versed in low level e-collar training in your area.

Your complete satisfaction is our only concern.

* This guide will familiarize you with the basic functions, programming features and the contents of the Pro Educator.
Additional information and help is available on www.ecollar.com and by e-mailing customerservice@ecollar.com.
To talk to a live team member please contact our customer service department, 8 AM to 8 PM E.S.T., 1-855-326-5527 or (260) 357-0051.

TABLE OF CONTENTS

- Characteristics 3
- Package Contents 4
- Capabilities and Features 5
- LCD Display Nomenclature 6
- Buttons Description and Stimulation Button Assignment 7
- Program Stimulation Buttons and Factory Default Setting 10
- Factory Default Setting 11
- Maximum Durations for Stimulation, Vibration, Tone 12
- Advanced Features 14
- Warranty and Registration 18

MEMO

WARRANTY AND REGISTRATION



To register your Pro Educator please select one of the following procedures

- (1) Go to the "Products" section on www.ecollar.com and click the "Register Your e-Collar Products" tab and complete the form
- (2) Fill out the provided warranty registration card and mail it or fax it to us at 1-855-226-5527.
- (3) Call us at (260) 357-0051 and one of our customer service representatives will register your products for you, please have your serial number available.

Two Year Full Warranty:

Your product is covered by our full two year warranty. During the warranty period we will repair and or replace your product for any reason due to workmanship and component failures. Dog chews and misuse are not covered by the warranty and are subject to a repair/replacement fee.

Important Notice to Consumer/User

In no event shall our company be liable for any direct, indirect, punitive, incidental, special consequential damages, to property or life, whatsoever arising out of or connected with the use or misuse of our products.

CHARACTERISTICS

- 1/2 mile Range
- Easily Expandable to 3 Dogs
- Waterproof and Shock Resistant
- User Adjustable Boosting Levels
- Lock and Set Stimulation Feature
- Collar Receiver Light for Night Tracking
- Stimulation Levels Adjustable from 0 to 100
- Employs Quick Charge Li-Polymer Batteries
- Computer Connection for Additional Features
- Patented "I" Mode Provides Instant Stimulation
- Convenient Intensity Dial for Quick Adjustment
- 6 Selectable Vibrations and 3 Selectable Tones
- 2 Ramping Modes, 1 Second and 2 Second Ramp Boost

PACKAGE CONTENTS

- Ergonomic Transmitter - Remote-Sender
- Waterproof Collar Receiver High Quality Biothane Strap
- Quick Start Owner's Guide

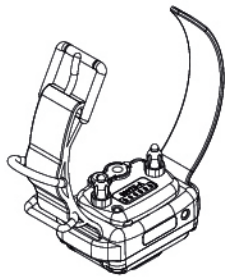
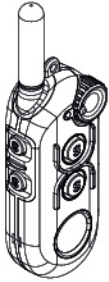

- Test Light
- Contact Point Tool
- 5/8" and 3/4" Contact Points

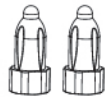
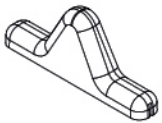

- Lanyard
- Battery Charger
- Metal Belt Clip

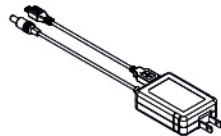

To add a 3rd collar receiver, change dog selection mode from 2D to 3D by pressing On/Off button plus S1 button.

* Pairing Procedure in the 3D Mode :

1. Confirm that Multi Dog Mode Indicator is Dog 3 Mode.
2. Press P button for more than 1 sec to enter into Button Program Mode.
3. Confirm all the icons are blinking and **PR** is displayed.
4. Press ON/OFF button four times to select  icon at LCD display.
5. Turn off the 3rd collar receiver. Hold the magnet for 5 seconds until the green light on the collar receiver flashes quickly.
6. Press S2 button to perform pairing with the 3rd collar receiver
7. Press P button to exit from Button Program Mode.

The Pro Educator can control up to 3 different dogs at the same time.

*** Pairing/Syncing Procedure in the 1D Mode :**

1. Confirm that Multi Dog Mode Indicator is Dog 1 Mode.
2. Press P button for more than 1 sec to enter into Button Program Mode.
3. Confirm all the icons are blinking and **PR** is displayed.
4. Press ON/OFF button four times to select  icon at LCD display.
5. Turn off the collar receiver. Hold the magnet for 5 seconds until the green light on the collar receiver flashes quickly.
6. Press any command button from S1 to S4 to perform pairing with Rx.
(Refer to Stimulation Button Assignment Table)
7. Press P button to exit from Button Program Mode.

To add dog 2's collar receiver, change dog selection mode from 1D to 2D by pressing On/Off button+S1 button.

*** Pairing Procedure in the 2D Mode :**

1. Confirm that Multi Dog Mode Indicator is Dog 2 Mode.
2. Press P button for more than 1 sec to enter into Button Program Mode.
3. Confirm all the icons are blinking and **PR** is displayed.
4. Press ON/OFF button four times to select  icon at LCD display.
5. Turn off the 2nd collar receiver. Hold the magnet for 5 seconds until the green light on the collar receiver flashes quickly.
6. Press S2 or S4 button to perform pairing with 2nd Rx.
(To replace 1st collar receiver, press S1 or S3 button.
Refer to Stimulation Button Assignment Table)
7. Press P button to exit from Button Program Mode.

Capabilities and Features

- Send Any of the Seven Stimulation Modes.
(Momentary, Momentary Boost, Continuous, Continuous Boost, Ramp, Ramp Boost, Instant Mode)
- Send Vibration or Tone.
- Turn ON/OFF Receiver Light.
- Program Boost Level for Each Dog.
- Activate/Deactivate Lost Transmitter Feature
- Lock/Unlock Current Stimulation Level.
- Control up to 3 Dogs

LCD DISPLAY NOMENCLATURE



Icon	Description	Action
M	Momentary Stimulation	Sends Single Pulse of Stimulation
M+	Momentary Boost Stimulation	Sends Single Pulse of Boosted Stimulation
C	Continuous Stimulation	Sends Continuous Pulses of Stimulation
C+	Continuous Boost Stimulation	Sends Continuous Pulses of Boosted Stimulation
R	1 Second Ramp Stimulation	Ramps Stimulation from 0 to Level Set by The Stimulation Dial
R+	2 Second Ramp Boosted Stimulation	Ramps Stimulation from 0 to Boosted Stimulation Level
I	Instant Stimulation Mode	Dial Controls Stimulation for up to 45 Seconds
V	Vibration	Vibration Sensation Similar to Cell Phone
T	Tone	Tone can be a Warning or a Good Warning or a Good Dog Marker
+	Boost Level Setting	Sets Boost Level for Each Dog
	Light	Turn ON/OFF Night Tracking Collar Receiver Light
	Lost Transmitter	6 Hours Timer Setting for Lost Transmitter Beeper
	Pairing/Syncing of Collar Receivers	Allows for "In the Field" Pairing of Receivers
1 2 3	Selection of Multi Dog Operation	Multi Dog Mode Indicator
88	Stimulation Level Indication	0 to 100 Levels of Precision Stimulation
	Battery Indicator	Indicates Transmitter Battery Level

* Turn ON/OFF Rx Light

1. Press P button for more than 1 sec to enter into Button Program Mode.
2. Confirm all the icons are blinking and **PR** is displayed.
3. Press ON/OFF button twice to select icon at LCD display.
4. Press any of stimulation control buttons to turn on/off the light of Receiver.

Light Activation Cycle of Receiver; Blinking - Solid - Off

5. Press P button to exit from Button Program Mode.

Lost transmitter mode is useful when you are going on a training trip and you want to be able to locate your transmitter. Remember, to plan ahead so the location beeper turns on at the appropriate time. It will start beeping 6 hours after the activation, turn off and back on the transmitter to turn off the lost transmitter beeper.

* Lost Transmitter

1. Press P button for more than 1 sec to enter into Button Program Mode.
2. Confirm all the icons are blinking and **PR** is displayed.
3. Press ON/OFF button three times to select icon at LCD display.
4. Press any of stimulation control button to turn on/off Lost Transmitter Function.
5. Press P button to exit from Button Program Mode.

ADVANCED FEATURES

You can enter into advanced feature mode by pressing the P-button for 1 second followed by the On/Off button.

* Boost Level Setup

1. Press P button for more than 1 sec to enter into Button Program Mode.
2. Confirm all the icons are blinking and **PR** is displayed.
3. Enter into "Boost Level Setup Mode" by pressing ON/OFF button one time.
4. Confirm **+** is selected at LCD display.
5. Rotate volume dial to setup boosting level from 1 to 60.
6. Save boosting level by pressing the Stimulation Button(S1~S4) which you want to set. (Refer to Button Assignment Table)
7. Press P button again to exit from Button Program Mode.

=====Or For A Quicker Procedure=====

1. Assign M+ or C+ function to any of stimulation button by pressing P button and stimulation button.
2. Confirm M+ or C+ is selected for this button.
3. Rotate volume dial to setup boosting level from 1 to 60.
4. Press this stimulation button again for more than 1sec to save the boosting level. Confirm icon(M+ or C+) blinked one time.
5. Press P button to save and exit from Button Program Mode.

Buttons Description and Stimulation Button Assignment

The Pro Educator has 4 control buttons that can be programmed to any one of the seven stimulation modes, vibration and/or tone.

The 2 program buttons for programming the control buttons and turning the unit ON and OFF are conveniently located on the right side.

The volume/stimulation dial provides for easy and sight free control of the stimulation level using your thumb.

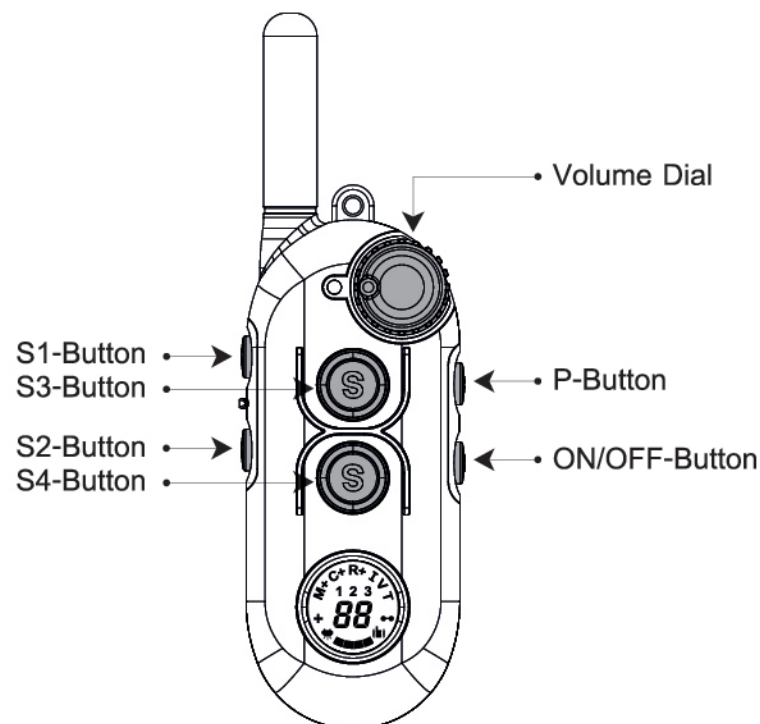

Control Buttons	Function	Action
ON/OFF	Power ON/OFF	Press 1 Second to Turn ON Press 2 Seconds to Turn OFF
P	Programs the Functions of the 4 Control Buttons; S1, S2, S3, and S4 Buttons. It also allows entry into the Tracking Light, Boost Level, Lost Transmitter Beeper, and Receiver Pairing Modes.	Press "P" for 1 Second to Enter Programming Mode. (Display will Flash) Press again to Exit the Mode. Or wait for the 30 Second Time Out Feature
Pressing the ON/OFF Button While in Programming Mode Toggles Through the Tracking Light, Boost Level, Lost Transmitter Beeper, and Receiver Pairing Modes	Turns ON/OFF Night Tracking Light, Selects Boost Level for Each Dog, Turns ON/OFF Lost Transmitter Beeper, Pairing/Syncing of Collar Receivers.	Toggles the Transmitter through the additional modes available on the Pro Educator
Pressing the ON/OFF Button and S1 Control Button at the same time.	Toggles Between Dog 1, Dog 2 and Dog 3 modes.	The LCD display will show 1, 2, or 3 and will provide a confirmation beep.

* Lock and Unlock Stimulation Level

1. Press "P" button for more than 1 sec to enter into Button Program Mode.
2. Confirm all the icons are blinking and **PR** is displayed.
3. Assign "M" or "C" function to any of the four control buttons by pressing that button until "M" or "C" are displayed.
4. Rotate the stimulation dial to the desired level; now push the particular control button for 1 second until the 1, 2, or 3 icon stops flashing. Solid icon indicates locked stimulation.
5. Press "P" button to save and exit from the Program Mode.
6. To unlock the locked stimulation level, repeat above step and confirm by noticing the 1, 2, or 3 dog icon is flashing.

Special Note: In the multi-dog modes, any of the dogs can be locked or unlocked.

Flashing icons indicate unlocked and solid icons indicate locked.

Maximum Durations for Stimulation, Vibration, Tone

- Continuous Stimulation "C" Mode : 10 Seconds.
- Continuous Boosted Stimulation "C+" Mode : 10 Seconds.
- Ramp "R" and Ramp Plus "R+" Modes : 10 Seconds
- Instant Stimulation "I" Mode : 45 Seconds
- Vibration and Tone Modes : 30 Seconds.

1. Assign instant stimulation "I" mode function to one of the control buttons.

IMPORTANT NOTICE : The stimulation dial must be turned to "0" to start the "I" mode.

2. To start the "I" push the assigned control button the display will flash

 and is ready to begin stimulation.

3. Turning the stimulation will now activate the stimulation at the setting of the dial and continue for 45 seconds.

Returning to "0" will reset the 45 second safety timer.

4. If you do not rotate the dial for 45 seconds the "I" mode will turn off and the control button will need to be pushed again.

5. Pushing any of the other control buttons will turn off the "I" mode and therefore require the "I" mode control be pushed again to reactivate it.

6. Again, to exit the Instant Mode, press any control button or wait for 45 seconds.

The 4 Control Buttons will be assigned to the Selected Dog pursuant to the following Table :

Control Buttons	Control Button Assignment Table		
	1 Dog Mode	2 Dog Mode	3 Dog Mode
S1-Button	Dog 1	Dog 1	Dog 1
S2-Button	Dog 1	Dog 2	Dog 3
S3-Button	Dog 1	Dog 1	Dog 1
S4-Button	Dog 1	Dog 2	Dog 2

Program Stimulation Buttons and Factory Default Setting

You can assign any 1 of the 9 functions to the S1, S2, S4 and S4 control buttons.

1. Press "P" button for more than 1 second until the LCD is flashing and **PR** is displayed.
2. Press the "S1" button repeatedly until you arrive at the function you desire for the "S1" button.
3. The default setting is "V" for the "S1", the sequence is as follows :



* **Note** : The "Lock and Set" feature is accomplished by selecting "M" or "C" mode and holding the "S1" button for one second before releasing it. Releasing it too soon will toggle to the next mode. The dog 1 icon will turn solid when in locked mode; flashing dog 1 icon indicates the stimulation is determined by the dial setting.

4. Repeat the same sequence for the S2, S3 and S4 buttons.

**** IMPORTANT NOTICE ****

* **Note** : Sometimes in the multi-dog mode the user needs to recall the settings and/or stimulation level setting of a particular dog because the display always shows the last dog stimulated. Simply enter the programming mode and push the particular dog button you want to recall the setting for, the first push will not change that setting.

5. Press "P" at any time in the programming to return to active use of the training collar.

Factory Default Setting

Control Buttons	Factory Default Settings					
	1 Dog Mode		2 Dog Mode		3 Dog Mode	
S1	1D	Vibration	1D	Vibration	1D	Vibration
S2	1D	Tone	2D	Vibration	3D	Vibration
S3	1D	Momentary	1D	Momentary	1D	Momentary
S4	1D	Instant Mode	2D	Momentary	2D	Vibration